

# Cliffside Apartment Homes

## INTERIOR FEATURES

\*Three-bedroom floor plans available

- Galley kitchen
- Cable ready
- Spacious closets

\*in select apartments

## AMENITIES

- Heat/hot water & electricity included
- Olympic size pool
- Tennis courts
- Basketball court
- Volleyball court
- Picnic area with barbecues
- Hiking and biking trails
- Professional landscaping
- Free public transportation
- 12 Clothing care facilities
- Private well water



**A community you will  
want to call home**

Cliffside Apartments is a scenic community nestled in the heart of the Pioneer Valley. Located in the Five College Area, it is just minutes away from downtown Amherst, a bustling, eclectic destination offering an exciting social scene complete with book stores, pubs, shops and cafes. Cliffside is also conveniently close to Route 9 where countless shopping plazas, grocery stores, and restaurants await.

As if that weren't enough, less than an hour away you'll find the Connecticut River, state parks, ski areas, Historic Deerfield, Yankee Candle Village, the Basketball Hall of Fame, Sturbridge Village, the Holyoke Mall, Magic Wings Butterfly Conservatory, and Six Flags Amusement Park.

There's something for everyone. Come make Cliffside your home!

## FLOOR PLANS

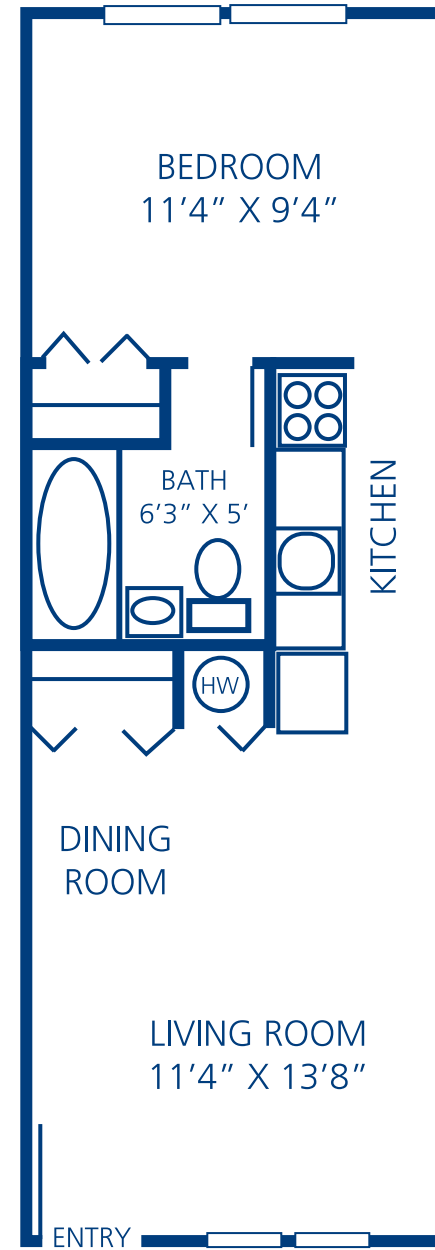

**A**

1 Bedroom/ 1 Bath  
Small  
400 Square Feet

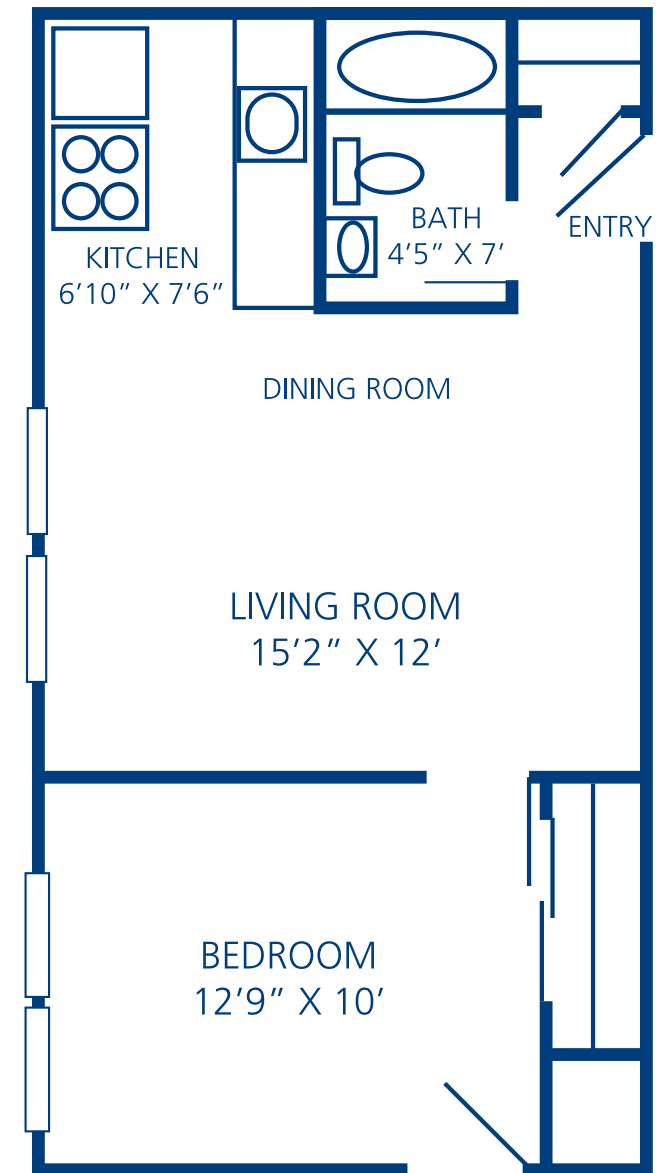

**B**

1 Bedroom/ 1 Bath  
Large  
475 Square Feet

# DIRECTIONS

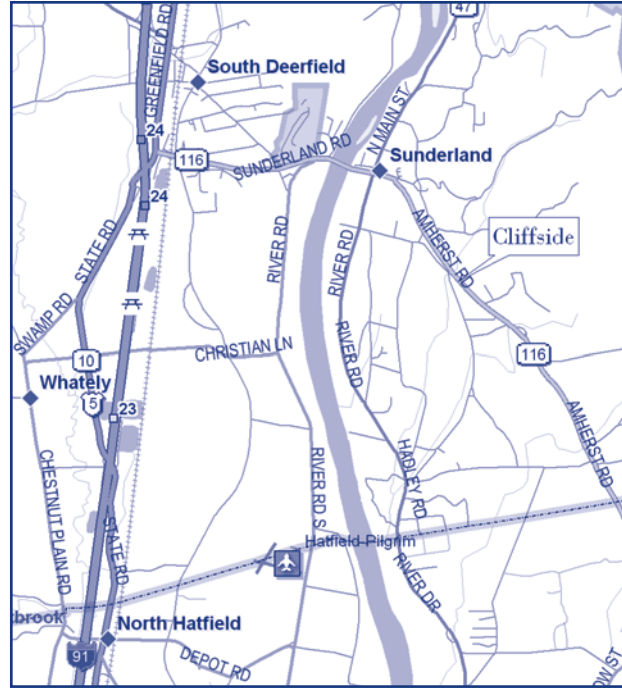

## Cliffside Apartment Homes

248 Amherst Road  
 Sunderland, MA 01375  
 Phone: 413.665.3958  
 Fax: 413.665.8267  
[cliffsideapts@northland.com](mailto:cliffsideapts@northland.com)



[www.northland.com](http://www.northland.com)

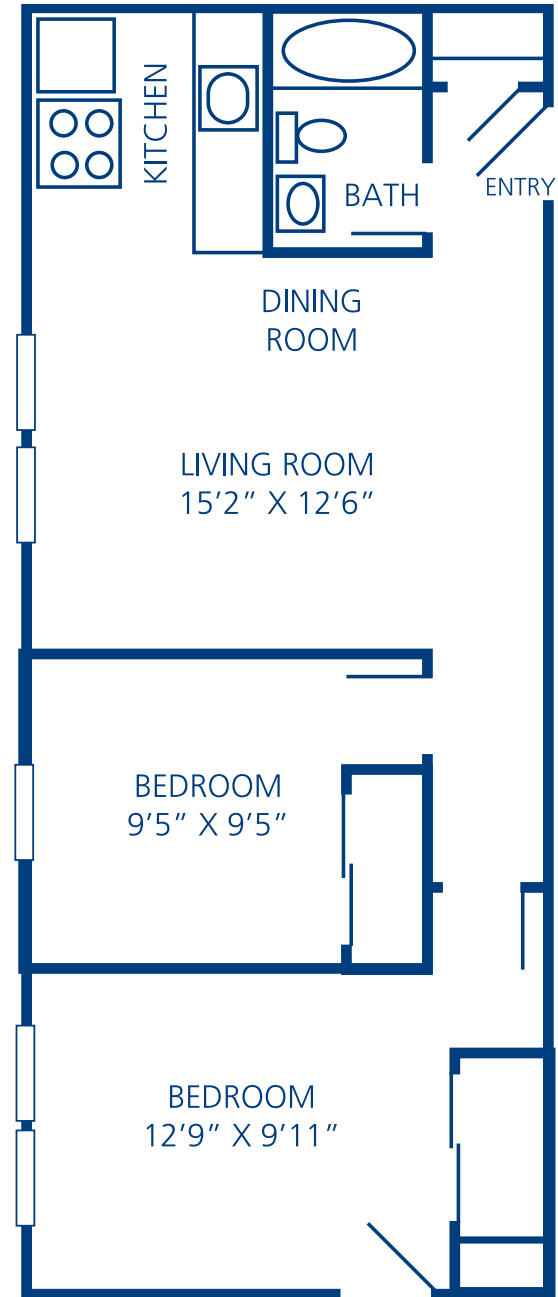

# C

2 Bedrooms/ 1 Bath  
 Garden  
 650 Square Feet

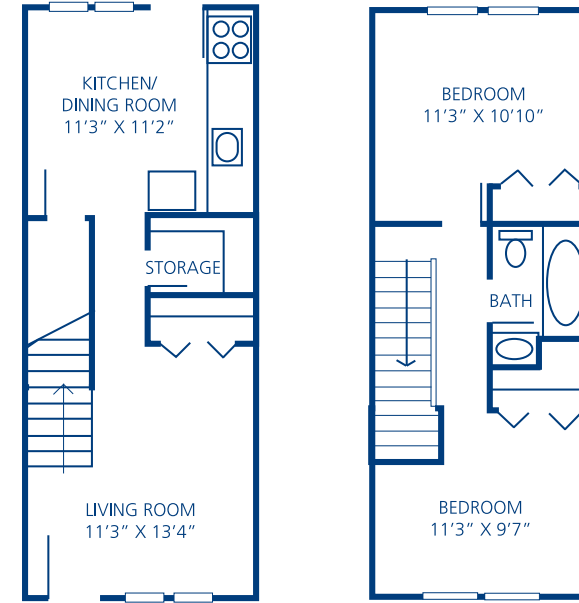

# D

2 Bedroom/ 1 Bath  
 Townhouse  
 900 Square Feet



# E

3 Bedroom/ 1 Bath  
 Garden  
 800 Square Feet

Providing Comfort, Convenience  
 and  
 Customer Service